

IP10

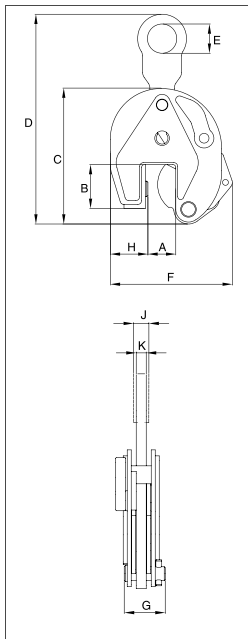

The IP10 vertical lifting clamp is used for the lifting, turning, moving or vertical transfer of sheet, plates, or fabrications from horizontal to vertical and down to horizontal (180°) as needed. Usually used as a single point pick or when used with a spreader beam with multiple vertical drop lines.



For Vertical Lifting, Turning and Transfer

- Available in capacities of .5 thru 30 metric tons (Higher Working Load Limits are available upon request).
- Wide variety of jaw openings available: 0" to 6.10".
- Welded alloy steel body for strength and smaller size. Forged alloy components, where required.
- Individually Proof Tested to 2 times the Working Load Limit with certification.
- Company name (CrosbyIP), logo, Working Load Limit and jaw opening permanently stamped on body.
- Each product is individually serialized, with the serial number and Proof Load test date stamped on body. Serial number is included on the test certificate with maintenance and warranty logbook.
- Available in a variety of styles:
 - IP10 - Standard clamp for materials with a surface hardness to 37Rc (345 HB).
 - IP10J - Larger jaw opening.
 - IP10S - For use with Stainless Steel material.
 - IP10H - For use with materials with a surface hardness to 47Rc (450 HB).
- Full 180° turning range for material transfer, turning or moving.
- Lock open, lock closed ability with latch for pretension on material and then release of material.
- Optional IP-5000 Stinger assembly available (see page 420). Allows for easy connection between the clamp and hoist hook.
- Minimum WLL of 10% of Maximum WLL.
- Maintenance replacement kits are available.
- Manufactured by a ISO 9001 facility.
- All sizes are **RFID EQUIPPED**.



Load Rated

Model IP10

Model	Working Load Limit (t)*	IP10 Stock No.	Weight Each (lbs.)	Dimensions (in.)									
				Jaw A	B	C	D	E	F	G	H	J	K
IP10	0.5	2701674	3.97	0 - .63	1.73	5.04	8.15	1.18	4.53	1.61	1.10	-	.39
IP10	1	2701662	4.85	0 - .75	1.77	5.47	8.46	1.18	4.96	1.61	1.50	-	.39
IP10	2	2701676	16.8	0 - 1.38	3.07	7.91	13.23	2.76	7.48	2.40	2.17	-	.63
IP10	3	2701664	30.4	0 - 1.56	3.94	9.96	17.17	2.95	8.86	3.07	2.36	-	.79
IP10	4.5	2701666	33.1	0 - 1.56	3.94	9.96	17.17	2.95	9.13	3.23	2.56	-	.79
IP10	6	2701668	51.9	0 - 2.00	4.96	11.89	20.28	3.15	11.50	3.31	3.74	1.57	.79
IP10/J	6	2701705	62.9	2.00 - 4.00	4.96	11.89	20.28	3.15	13.46	3.31	3.74	1.57	.79
IP10	9	2701670	60.7	0 - 2.00	4.96	12.80	21.65	3.15	12.20	3.62	4.13	1.73	.79
IP10/J	9	2701672	62.9	2.00 - 4.00	4.96	12.80	21.85	3.15	14.17	3.62	4.13	1.73	.79
IP10	12	2701678	108	0 - 2.13	6.30	15.39	22.83	3.16	13.03	4.61	5.39	1.61	.98
IP10/J	12	2701680	128	2.13 - 4.25	7.01	17.28	24.80	3.15	16.34	4.61	5.39	1.61	.98
IP10	16	2701682	150	.25 - 2.50	7.01	18.31	27.17	3.46	15.63	4.69	6.02	1.93	.98
IP10/J	16	2701684	199	2.50 - 5.00	8.19	20.51	29.37	3.46	18.58	4.69	6.34	1.93	.98
IP10	22.5	2701686	238	.25 - 3.13	8.74	21.81	31.50	4.33	18.50	5.35	7.32	1.93	.98
IP10/J	22.5	2701688	243	3.13 - 6.10	9.96	24.72	34.65	4.33	22.64	5.35	7.72	1.93	.98
IP10	30	2701690	327	.25 - 3.13	8.74	21.46	31.50	4.33	18.50	5.98	7.32	2.13	1.18
IP10/J	30	2701692	335	3.13 - 6.10	9.84	24.41	34.65	4.33	22.24	5.98	7.72	2.13	1.18
For stainless steel - with fixed hoisting eye													
IP10/S	0.5	2702274	3.97	0 - .63	1.73	5.04	8.15	1.18	4.53	1.61	1.10	-	.39
IP10/S	1	2702262	4.41	0 - .75	1.77	5.47	8.46	1.18	4.96	1.61	1.50	-	.39
IP10/S	2	2702276	15.0	0 - 1.38	3.07	7.91	13.23	2.76	7.48	2.40	2.17	-	.63
IP10/S	3	2702264	30.5	0 - 1.56	3.94	9.96	17.17	2.95	8.86	3.07	2.36	-	.79
IP10/S	4.5	2702266	33.1	0 - 1.56	3.94	9.96	17.17	2.95	9.13	3.23	2.56	-	.79
IP10/S	6	2702268	51.9	0 - 2.00	4.96	11.89	20.67	3.15	11.50	3.31	3.74	1.57	.79
IP10/S	9	2702270	60.7	0 - 2.00	4.96	12.80	21.93	3.15	12.20	3.62	4.13	1.73	.98
IP10/S	12	2702278	108	0 - 2.13	6.30	15.39	24.53	3.15	13.03	4.61	5.39	1.61	.98
For very hard materials - with fixed hoisting eye													
IP10/H	0.5	2702174	3.97	0 - .63	1.73	5.04	8.15	1.18	4.53	1.61	1.10	-	.39
IP10/H	1	2702176	15.0	0 - 1.38	3.07	7.91	13.23	2.76	7.48	2.40	2.17	-	.39
IP10/H	2	2702164	30.4	0 - 1.56	3.94	9.96	17.17	2.95	8.86	3.07	2.36	-	.63
IP10/H	3	2702166	33.1	0 - 1.56	3.94	9.96	17.17	2.95	9.13	3.23	2.56	-	.79
IP10/H	4.5	2702168	51.9	0 - 2.00	4.96	11.89	20.28	3.15	11.50	3.31	3.74	1.57	.79
IP10/H	6	2702170	60.7	0 - 2.00	4.96	12.80	21.65	3.15	12.20	3.62	4.13	1.73	.98

* Design Factor based on EN 13155 and ASME B30.20.

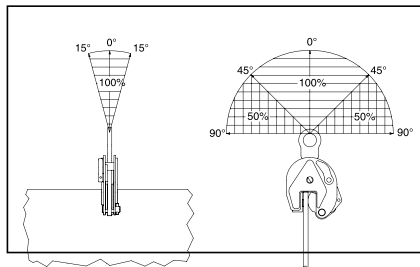

Industrial Rigging & Supply

Copyright © 2013 The Crosby Group LLC All Rights Reserved