

IPH10E

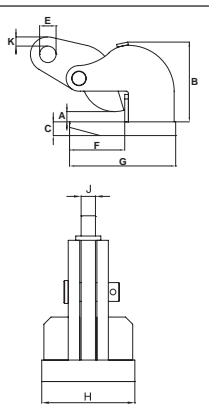

The IPH10E / IPH10JE horizontal lifting clamps are for use in the lifting and transfer in horizontal position of non-sagging materials or of bundles of non-sagging material. These clamps must be used in pairs or more.

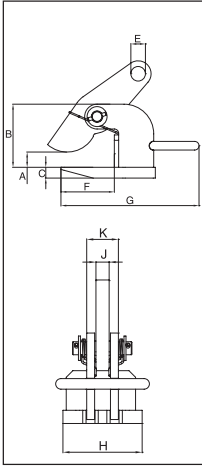

For Horizontal Lifting and Transfer

- Available in capacities of .75 thru 25 metric tons.
- Wide variety of jaw openings available: 0 to 120mm.
- Welded alloy steel body for strength and smaller size. Forged alloy components, where required.
- Equipped with handle for easy placement.
- Individually Proof Tested to 2 times the Working Load Limit with certification.
- Company name (CrosbyIP), logo, Working Load Limit and jaw opening permanently stamped on body.
- Each product is individually serialized, with the serial number and Proof Load test date stamped on body. Serial number is included on the test certificate with maintenance and warranty logbook.
- Maintenance replacement parts are available.
- Manufactured by a ISO 9001 facility.
- All sizes are **RFID EQUIPPED**.



IPHOZ



The IPHOZ horizontal lifting clamp is to be used for lifting and transferring, in the horizontal position, of thin sheet and other materials that will sag or bend when lifted. These clamps must be used in pairs or more.

Model IPH10E: Jaw opening range 0 to 2.36in

Model	Working Load Limit (Per Pair) (t)*	IPHTONZ Stock No.	Weight Each (lbs.)	Dimensions (in)								
				Jaw A	B	C	E	F	G	H	J	K
IPH10E	2	2703542	12.1	0 - 2.36	4.61	.63	.87	4.29	10.1	4.33	.79	1.58
IPH10E	3	2703543	16.5	0 - 2.36	4.61	.79	1.02	4.29	10.5	4.73	.79	1.89
IPH10E	4.5	2703544	23.2	0 - 2.36	5.20	.99	1.18	4.10	11.0	5.12	.79	1.89
IPH10E	6	2703545	28.7	0 - 2.36	5.63	.99	1.42	4.85	12.6	5.12	.79	1.89
IPH10E	9	2703546	40.8	0 - 2.36	6.19	1.18	1.69	5.24	13.0	5.52	.99	2.44
IPH10E	12	2703547	47.4	0 - 2.36	6.78	1.18	1.85	5.56	13.9	5.91	.99	2.44
IPHOZ	25	2705119	86.0	0 - 2.38	6.65	1.57	1.85	6.69	11.81	8.66	1.26	.87

* Design Factor based on EN 13155 and ASME B30.20.

Model IPH10JE: Jaw opening range 2.36 to 4.73"

Model	Working Load Limit (Per Pair) (t)*	IPH10JE Stock No.	Weight Each (lbs.)	Dimensions (in)									
				Jaw A	B	C	E	F	G	H	J	K	L
IPH10JE	3	2703553	19.8	2.36 - 4.73	6.97	.79	1.02	4.29	10.5	4.73	.79	1.89	.43
IPH10JE	4.5	2703554	26.5	2.36 - 4.73	7.56	.99	1.18	4.10	11.0	5.12	.79	1.89	.47
IPH10JE	6	2703555	33.0	2.36 - 4.73	8.00	.99	1.42	4.85	12.6	5.12	.79	1.89	.55
IPH10JE	9	2703556	45.2	2.36 - 4.73	8.55	1.18	1.69	5.24	13.0	5.52	.99	2.44	.63
IPH10JE	12	2703557	25.9	2.36 - 4.73	9.14	1.18	1.85	5.56	13.9	5.91	.99	2.44	.67

* Design Factor based on EN 13155 and ASME B30.20.

Model IPHOZ: Jaw opening range 0 to 2.38"

Model	Working Load Limit (Per Pair) (t)*	IPHOZ Stock No.	Weight Each (lbs.)	Dimensions (in)								
				Jaw A	B	C	E	F	G	H	J	K
IPHOZ	0.75	2705401	6.60	0 - 1.19	3.70	.63	.63	2.76	4.65	3.19	.47	.47
IPHOZ	1.5	2705402	12.1	0 - 1.75	5.24	.63	.87	4.92	7.56	3.94	.63	.47
IPHOZ	3	2705403	17.6	0 - 1.75	5.39	.79	1.02	4.92	7.87	4.72	.79	.39
IPHOZ	4.5	2705404	18.7	0 - 1.75	5.43	.98	1.18	4.96	8.66	4.72	.79	.39
With larger jaw opening												
IPHOZ	6	2705405	34.2	0 - 2.38	6.73	1.18	1.42	5.31	9.25	5.12	.79	.79
IPHOZ	9	2705406	45.2	0 - 2.38	8.31	1.18	1.69	6.54	10.87	6.30	.98	.79
IPHOZ	12	2705407	83.8	0 - 2.38	8.54	1.57	1.85	6.61	11.57	7.48	.98	.75
IPHOZ	15	2705408	83.8	0 - 2.38	8.66	1.57	1.85	7.20	12.48	9.84	.98	.87

* Design Factor based on EN 13155 and ASME B30.20.

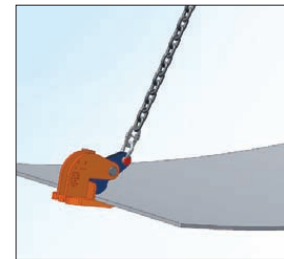
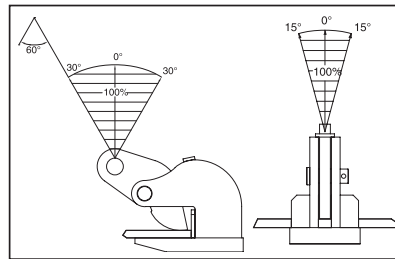
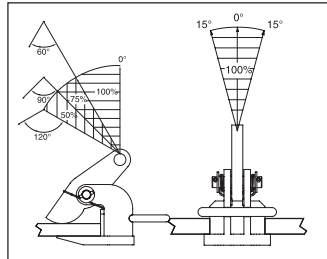

Industrial Rigging & Supply

Copyright © 2013 The Crosby Group LLC All Rights Reserved