



- Work Load Limits available 1/3 through 150 metric tonnes, grade 6.
- Working Load Limit and grade "6" permanently shown on every shackle.
- Forged – Quenched and Tempered, with alloy pins.
- Hot Dip galvanized or Self Colored. (85, 120, and 150 metric tonne shackles are all hot dip galvanized bows and the bolts are Dimetcoated® and painted red)
- Fatigue rated (1/3t - 55t).
- Approved for use at -40 degree C (-40 degree F) to 204 degree C (400 degree F).
- Meets or exceeds all requirements of ASME B30.26.
- Shackles 85 metric tonnes and larger are individually proof tested to 2.0 times the working load limit.
- Shackles 120 metric tonnes and larger are proof tested, Magnetic Particle Inspected and provided with Serialized Pin and Bow.
- Crosby 2t through 25t G2130 anchor shackles are type approved to DNV Certification Notes 2.7-1-Offshore Containers. These Crosby shackles are statistical proof and impact tested to 42 joules (31 ft-lbs.) min. ave. at -20 degree C (-4 degree F). The tests are conducted by Crosby and 3.1 test certification is available upon request. Refer to page 76 for Crosby COLD TUFF® shackles that meet the additional requirements of DNV rules for certification of lifting applications - Loose Gear.
- All other 2130 and all 2150 shackles can meet charpy requirements of 42 joules (31 ft-lbs) avg at -20 degree C (-4 degree F) upon special request.
- Look for the Red Pin . . . the mark of genuine Crosby quality.



Nominal Size (in.)	Working Load Limit (t)*	Stock No.		Weight Each (lbs.)	Dimensions (in.)										Tolerance +/-	
		G-2130	S-2130		A	B	C	D	E	F	H	L	N	C	A	
3/16	1/3 ‡	1019464	-	.06	.38	.25	.88	.19	.60	.56	1.47	.98	.19	.06	.06	
1/4	1/2	1019466	-	.11	.47	.31	1.13	.25	.78	.61	1.84	1.28	.25	.06	.06	
5/16	3/4	1019468	-	.22	.53	.38	1.22	.31	.84	.75	2.09	1.47	.31	.06	.06	
3/8	1	1019470	-	.33	.66	.44	1.44	.38	1.03	.91	2.49	1.78	.38	.13	.06	
7/16	1-1/2	1019471	-	.49	.75	.50	1.69	.44	1.16	1.06	2.91	2.03	.44	.13	.06	
1/2	2	1019472	1019481	.79	.81	.64	1.88	.50	1.31	1.19	3.28	2.31	.50	.13	.06	
5/8	3-1/4	1019490	1019506	1.68	1.06	.77	2.38	.63	1.69	1.50	4.19	2.94	.69	.13	.06	
3/4	4-3/4	1019515	1019524	2.72	1.25	.89	2.81	.75	2.00	1.81	4.97	3.50	.81	.25	.06	
7/8	6-1/2	1019533	1019542	3.95	1.44	1.02	3.31	.88	2.28	2.09	5.83	4.03	.97	.25	.06	
1	8-1/2	1019551	1019560	5.66	1.69	1.15	3.75	1.00	2.69	2.38	6.56	4.69	1.06	.25	.06	
1-1/8	9-1/2	1019579	1019588	8.27	1.81	1.25	4.25	1.13	2.91	2.69	7.47	5.16	1.25	.25	.06	
1-1/4	12	1019597	1019604	11.71	2.03	1.40	4.69	1.29	3.25	3.00	8.25	5.75	1.38	.25	.06	
1-3/8	13-1/2	1019613	1019622	15.83	2.25	1.53	5.25	1.42	3.63	3.31	9.16	6.38	1.50	.25	.13	
1-1/2	17	1019631	1019640	19.00	2.38	1.66	5.75	1.53	3.88	3.63	10.00	6.88	1.62	.25	.13	
1-3/4	25	1019659	1019668	33.91	2.88	2.04	7.00	1.84	5.00	4.19	12.34	8.80	2.25	.25	.13	
2	35	1019677	1019686	52.25	3.25	2.30	7.75	2.08	5.75	4.81	13.68	10.15	2.40	.25	.13	
2-1/2	55	1019695	1019702	98.25	4.13	2.80	10.50	2.71	7.25	5.69	17.90	12.75	3.13	.25	.25	
3	† 85	1019711	-	154.00	5.00	3.30	13.00	3.12	7.88	6.50	21.50	14.62	3.62	.25	.25	
3-1/2	† 120 ‡	1019739	-	265.00	5.25	3.76	14.63	3.62	9.00	8.00	24.88	17.02	4.38	.25	.25	
4	† 150 ‡	1019757	-	338.00	5.50	4.26	14.50	4.00	10.00	9.00	25.68	18.00	4.56	.25	.25	

G-2130 / S-2130
 G-2130 Bolt Type Anchor shackles with thin head bolt - nut with cotter pin. Meets the performance requirements of Federal Specification RR-C-271F Type IV A, Grade A, Class 3, except for those provisions required of the contractor. For additional information please go to the latest edition of the Crosby Catalogue or visit www.thecrosbygroup.com

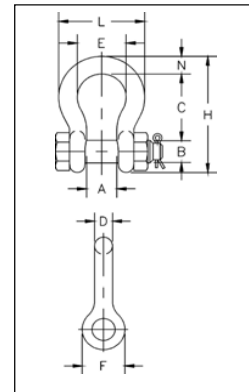

*** NOTE: Maximum Proof Load is 2.0 times the Working Load Limit.
 Minimum Ultimate Strength is 6 times the Working Load Limit**

Limit

For Working Load Limit reduction due to side loading applications, please consult the latest edition of the Crosby General Catalogue or go to www.thecrosbygroup.com

† Individually Proof Tested with certification.

‡ Furnished in Anchor style only and furnished with Round Head Bolts with welded handles

INCLUDED ANGLE - SHACKLES

Never exceed 120° included angle. Use Bolt Type and Screw Pin Shackles ONLY.

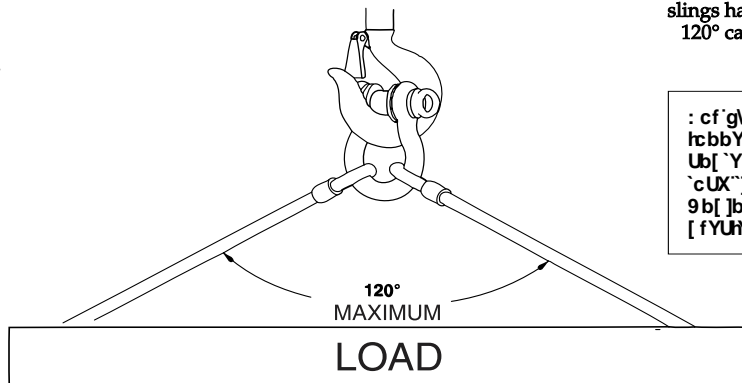

Shackles symmetrically loaded with two leg slings having a maximum included angle of 120° can be utilized to full Working Load Limit.

: cf g] UW`Yg`Uf[Yf`h Ub`%&] `a Yff]W
 hbbYgZ]h Ya Ul]a i a]bWi XYX`
 Ub[`Y]g`- \$ XY[fYYg`Zf`Z `k cf]_b[` `cUX`ja]H`7 cbHUM7 fcgVm
 9b[]bYf]b[]Z]bWi XYX`Ub[`Y]g`
 [fYUhf`h Ub`- \$ XY[fYYg`



Industrial Rigging & Supply

Copyright © 2013 The Crosby Group LLC All Rights Reserved